



# VERTIGO



## USER MANUAL



VER. 2.0

© Copyright by **FLY Products** s.r.l.

Via Perù n. 30

63013 GROTTAMMARE (AP) - ITALY

tel./fax +39.735.632486

[www.flyproducts.com](http://www.flyproducts.com) - ✉ [fly@flyproducts.com](mailto:fly@flyproducts.com)

WHITE PAGE

# Index

<i>Chapter</i>	<i>Description</i>
1.0	VERTIGO FEATURES
2.0	OVERALL DIMENSIONS
3.0	FRAME ASSEMBLY
4.0	PROTECTION CAGE ASSEMBLY
5.0	EMERGENCY PARACHUTE
6.0	WARRANTY

# 1 – VERTIGO FEATURES

The trike Vertigo is designed to be particularly strong and stable during all phases of takeoff and landing. Its low center of gravity makes it very stable in all the maneuvers. In flight surprises its ability to counteract the torque effect due to the rotation of the propeller. The seat is very comfortable. The front is adjustable and adapted to the height of several pilots. On this Trike is possible to install any paramotor Fly Products and the new frame Easy Removal.

## Technical features

Available Engine Type =	Moster 185, Moster Factory R, Thor 202, Thor 303, Cosmos 300.
Weight without engine =	35 Kg. / 77.1 lbs.
Fuel Tank =	16 Lt. / 4.2 gal.
Propeller length =	150 cm / 59.0 in.
Overall Dim. LENGHT =	198 cm / 77,9in.
Overall Dim. WIDTH =	180 cm / 70,8 in.
Overall Dim. HEIGHT =	180 cm / 70,8 in.

## Available optionals

Cockpit



RPM/Hour counter



Digital altimeter



USB port



Rescue system



## 2 – OVERALL DIMENSIONS

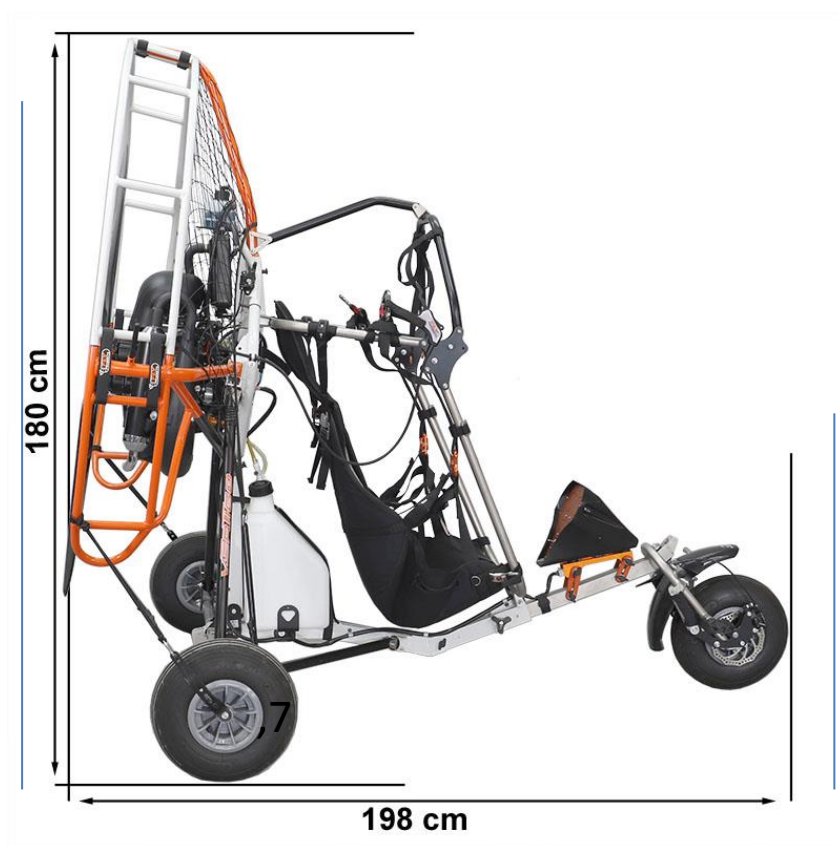

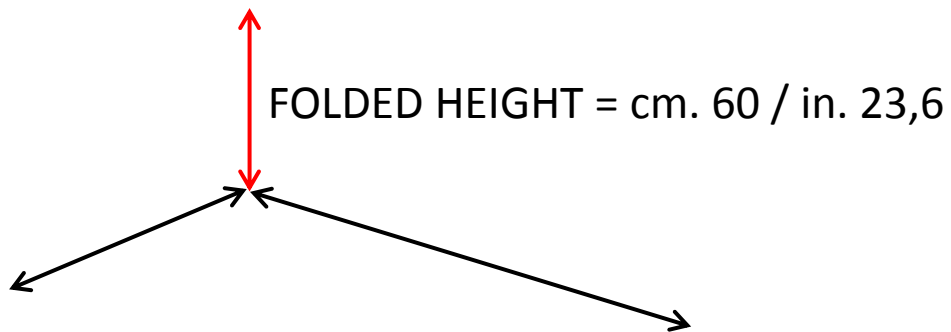
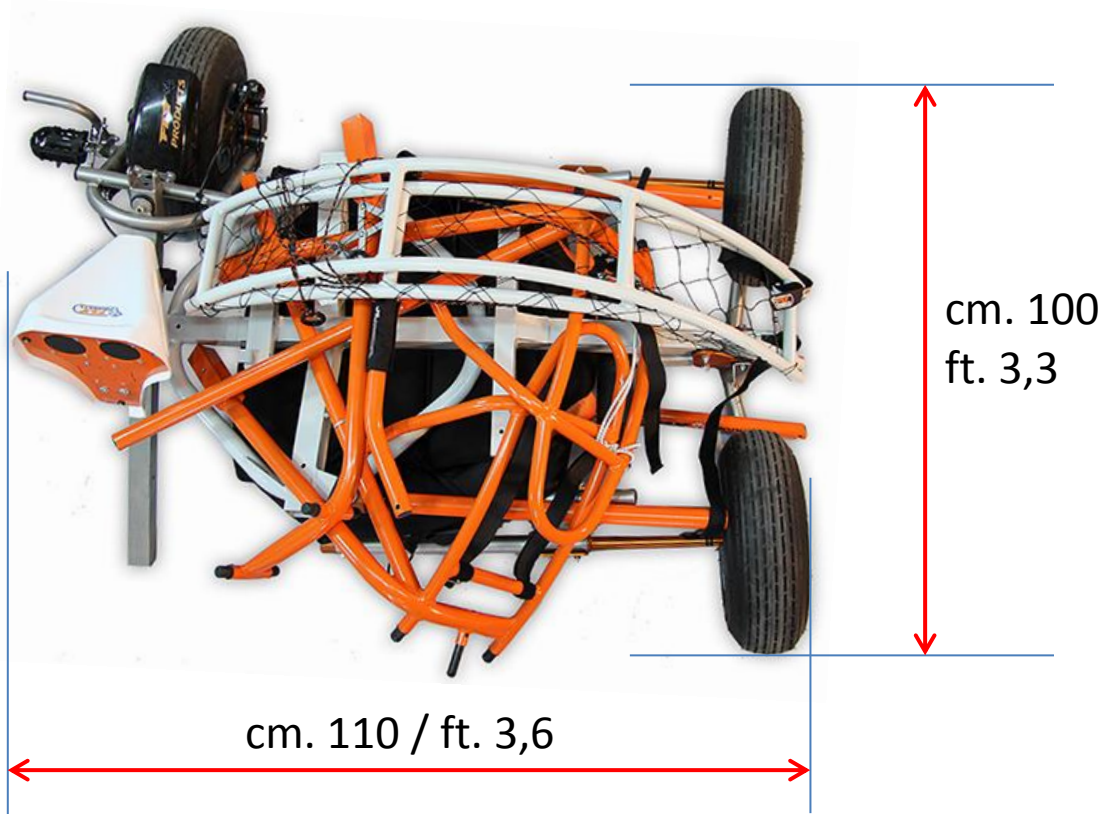

## 3 – FRAME ASSEMBLY

Frame assembly and disassembly is very fast and easy.  
The best way is to proceed in the following order:

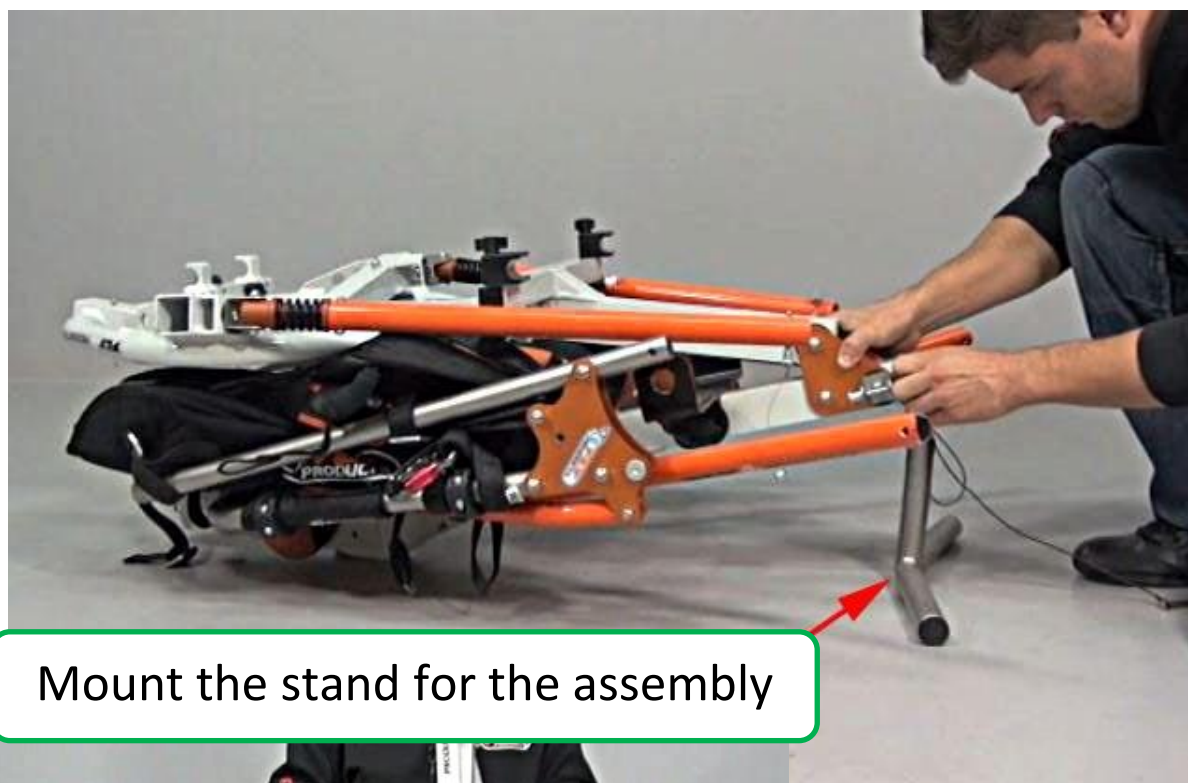

Mount the stand for the assembly



Open the cradle

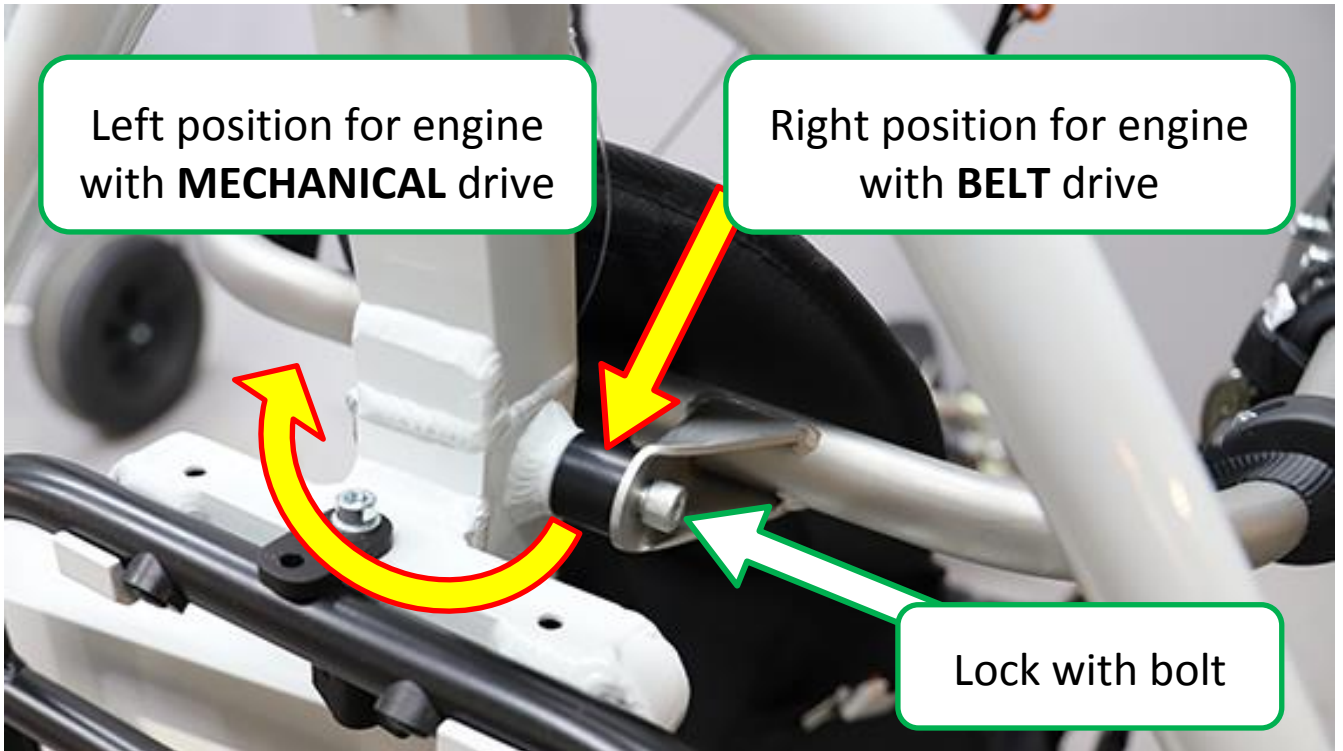

To counteract the torque generated by the engine, mount the upper and front cradle SPACER according to the type of transmission of the installed engine.  
**! Both spacers must always be on the same sides !**

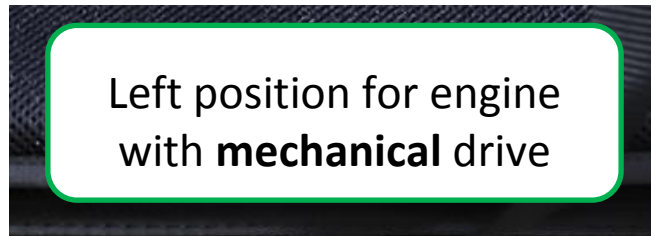
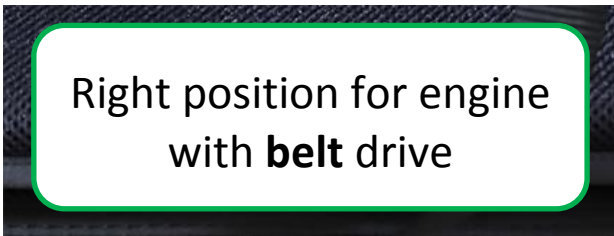



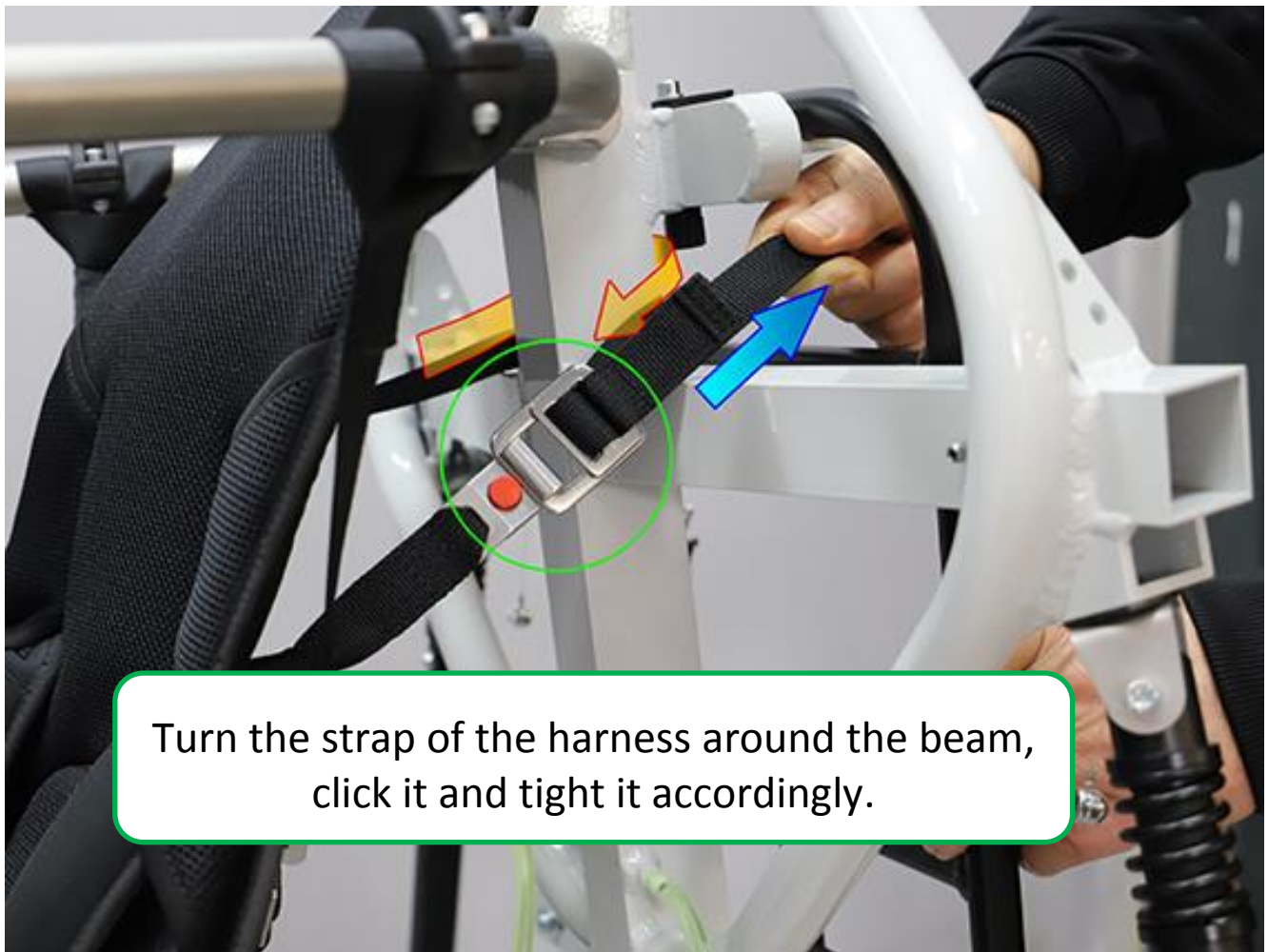

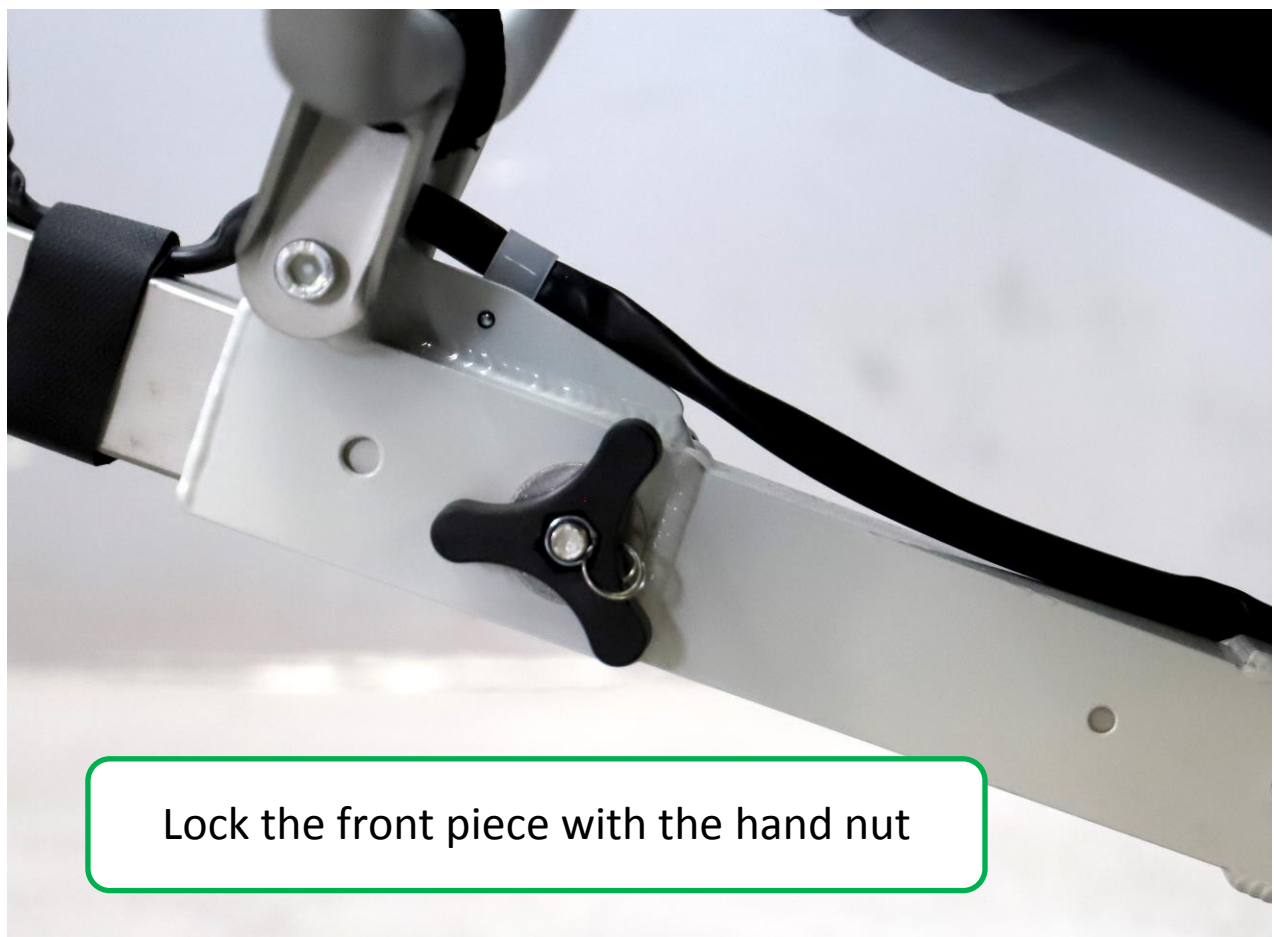

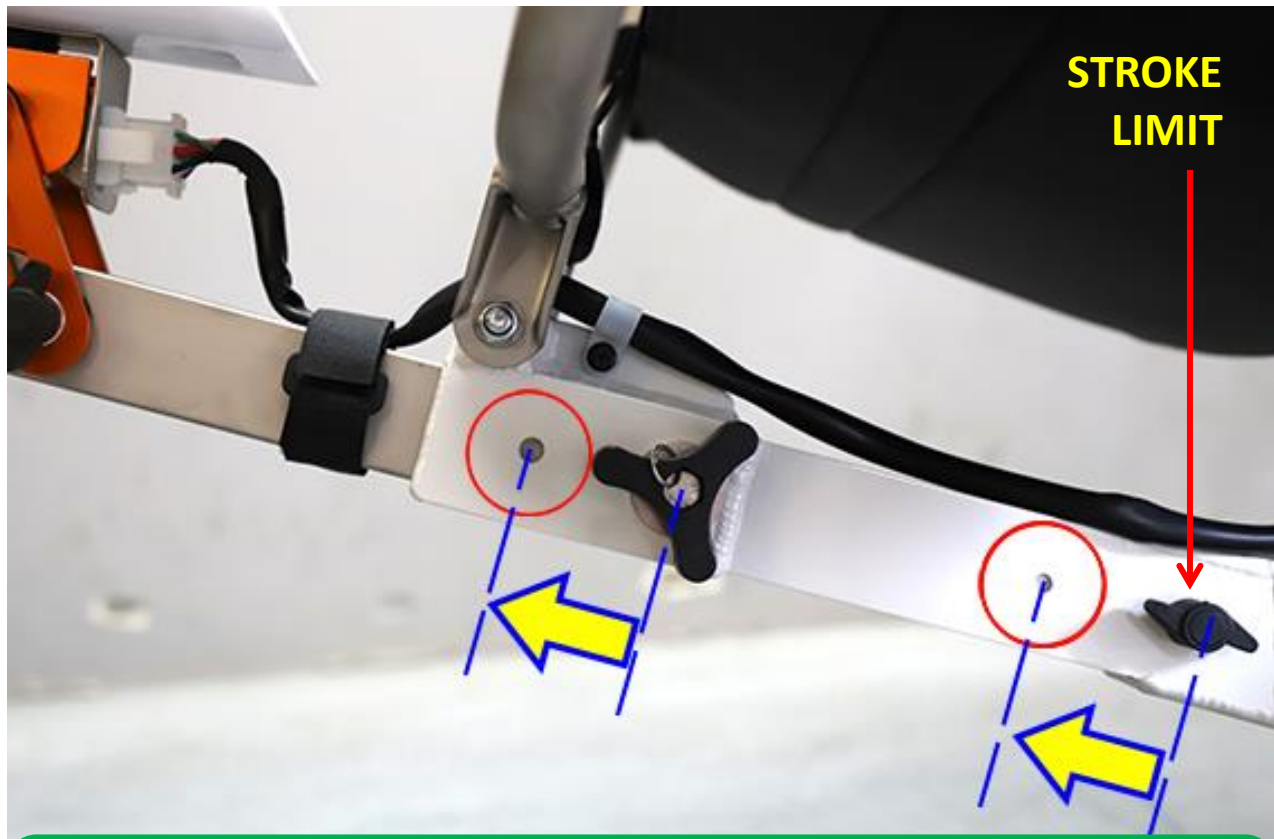

And 'possible to adjust the length of the lower part by moving the bolt back and forth (55 mm/2,1in.)

Place the rear leg and insert the push pin

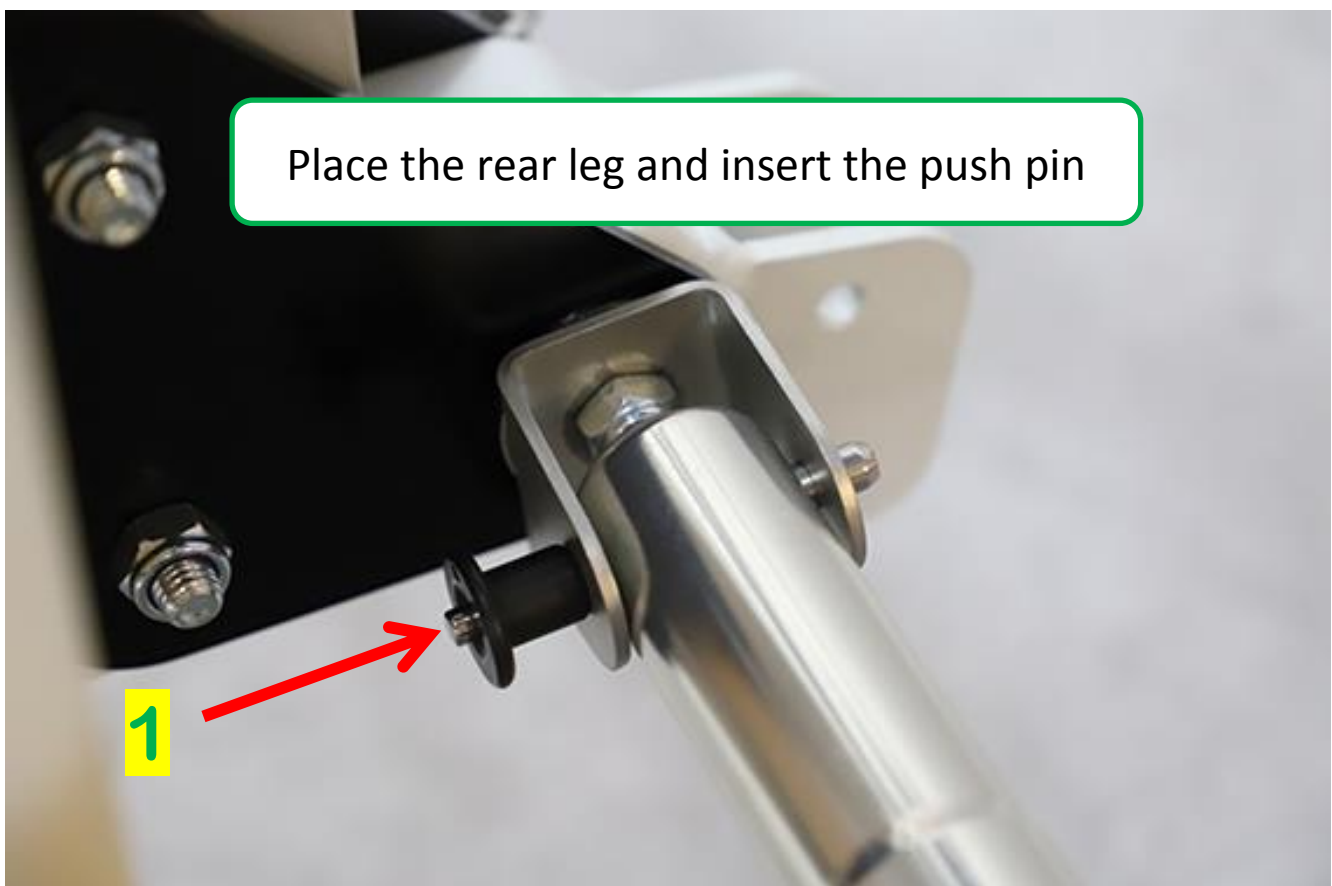

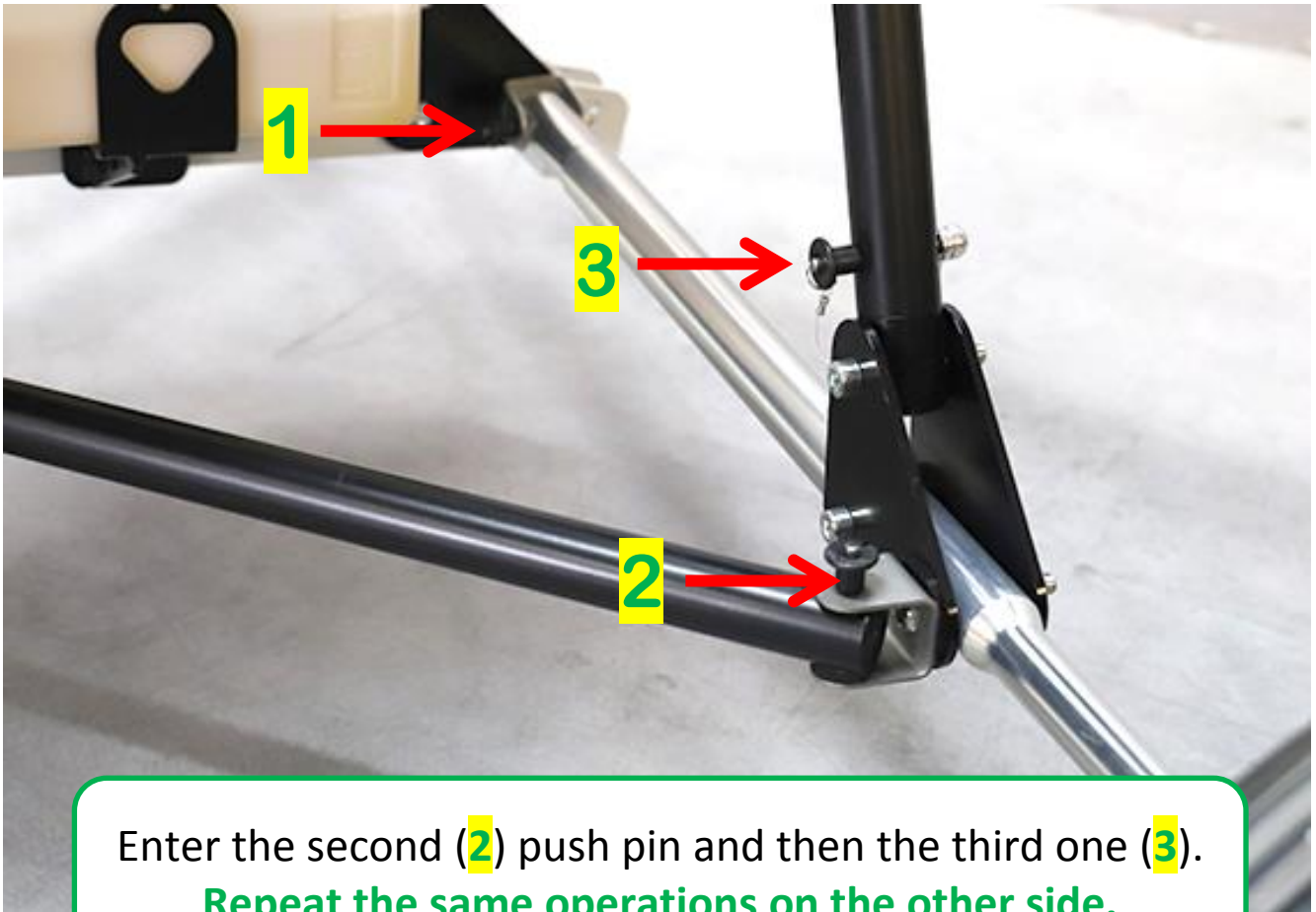

**REMOVE  
THE STAND**



**Do not fly with the  
stand installed!**

**This completes the  
basic assembly  
of the trike,  
after which  
the propeller  
protection cage  
can be assembled.**

## 4 – PROTECTION CAGE ASSEMBLY

The outer frame consists of four parts, and they are held together by the velcro straps.





Position the side of the cage parts and insert the first push in the lower insert/slot.  
**Repeat the same operation on the other side.**



Position the side of the cage parts and insert the second push pin at the top.

**Repeat the same operation on the other side.**

Secure  
the  
upper bar  
with  
its  
push pin







Mount  
the upper  
cage  
and  
close  
all  
Velcros

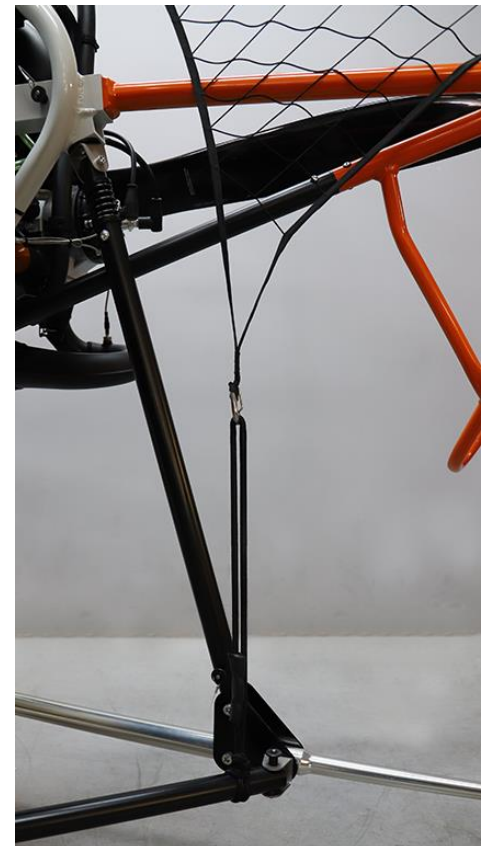

Pull the cage net and secure it  
to the elastic loop

Position the elastic cord for the lines protection and hook it to the provided support.



Finish by placing and securing the tank with it's own velcro strap.

## 5 – EMERGENCY PARACHUTE

Assembly procedure of the emergency system:



**BRIDLE ALWAYS ON THE OUTSIDE !**



RESCUE BRIDLE POSITION ON CARABINER

## 6 – WARRANTY

### Warranty

Fly Products (Seller, Our, Us) warrants the original Purchaser that this product shall be free from defects in materials and workmanship under normal use for a period of 12 months from the date of purchase. If for any reason this product is powered by fuel that does not meet the criteria stated in the engine manual, or is used with other equipment, parts or replaceable items (such as consumables) which are neither made nor approved by Fly products, Fly Products shall not be responsible for any loss of quality, degradation of performance or actual damage that results from the use of such fuel, equipment, parts or replaceable items.

Seller obligation and liability under this warranty is expressly limited to repairing or replacing, at Seller's option, any product not meeting the specifications. The dealer, from whom you purchased the product, or Fly Products, will repair the product free-of-charge. In no event shall Fly Products be liable to the Purchaser or any other person for any loss or damage whether direct or indirect or consequential or incidental, including without limitation, any damages or claims by third parties caused by defective products or otherwise arising from the incorrect or otherwise improper use of this product. This warranty applies only to defects in parts and workmanship relating to normal use.

It does not cover:

- damage arising from improper maintenance or negligence
- damage caused by incorrect pilot operation
- damage caused by wind or adverse weather conditions
- fair wear and tear

Fly Products shall, at its option, repair or replace any defective products. Improper use, that is, use for purposes other than those mentioned in this manual will void the warranty.

Limited warranty Fly Products shall not be liable to the Purchaser or any other person for damage arising from improper storage, handling or use of this product. Repairs to this Product must be carried out by qualified technicians appointed by Fly Products. This Product must be assembled in accordance with the instructions in this manual. To obtain warranty service, please contact your dealer or Fly Products directly. Shipping charges are the responsibility of the purchaser.

Internet info and upgrade

For information, more details and news see our internet site: [www.flyproducts.com](http://www.flyproducts.com)



© Copyright by **FLY PRODUCTS** s.r.l.  
Via Perù 30  
63013 GROTTAMMARE (AP) - ITALY  
tel./fax +39.735.632486  
[www.flyproducts.it](http://www.flyproducts.it) - ✉ fly@flyproducts.it